

EMERGENCY LIGHTING - SEE ELECTRICAL SPEC GENERALLY  
 EMERGENCY LIGHTING SHOULD BE PROVIDED TO THE  
 PROPOSAL AND SHOULD BE INSTALLED TO COMPLY WITH BS  
 5266: PART 1:2011.

DOORS  
 DOORS ON ESCAPE ROUTES SHOULD BE FITTED WITH VISION  
 PANELS - AS PER DOOR SCHEDULE

FIRE ALARM  
 ANY ALTERATIONS OR ADDITIONS TO THE FIRE ALARM SYSTEM  
 SHOULD BE LINKED INTO THE EXISTING FIRE ALARM SYSTEM  
 AND SHOULD BE INSTALLED TO COMPLY WITH BS 5839: PART  
 1:2013.

SIGNAGE  
 FIRE DOORS FITTED WITH SELF CLOSING DEVICES SHOULD  
 HAVE A NOTICE 'FIRE DOOR-KEEP SHUT' FIXED TO BOTH SIDES  
 OF THE DOOR AT ABOUT EYE LEVEL.  
 DOORS FITTED WITH PUSH PAD SHOULD HAVE A NOTICE 'PUSH  
 BAR TO OPEN' IN CONSPICUOUS LETTERS SUITABLY MOUNTED  
 ON THE DOOR.  
 ALL NOTICES AND SIGNS SHOULD COMPLY WITH THE HEALTH  
 AND SAFETY (SAFETY SIGNS AND SIGNALS) REGULATIONS 1996.  
 SIGNS CONFORMING TO BS ISO 3864-1:2011. GRAPHICAL  
 SYMBOLS, SAFETY COLOURS AND SAFETY SIGNS.

INTERNAL PARTITIONS  
 INTERNAL PARTITION WALLS TO BE 75MM X 50MM SOFTWOOD  
 FRAMED STUD PARTITION WALLS WITH 12.5MM PLASTERBOARD  
 BOTH SIDES AND A PLASTER SKIM FINISH. ALL OF THE NEW  
 INTERNAL STUD WALLS ARE TO HAVE AN ABSORBENT LAYER OF  
 UNFACED MINERAL WOOL BATTS OR QUILT (MINIMUM  
 THICKNESS 25 MM, MINIMUM DENSITY 10 KG /M<sup>3</sup>) WIRE  
 REINFORCED, SUSPENDED IN THE CAVITY ALL JOINTS WELL  
 SEALED.  
 DECORATE TO NEW WALLS & THROUGHOUT: 1 COAT PRIMER  
 AND TWO COATS DULUX DIAMOND MATT EMULSION, ALL IN  
 ACCORDANCE TO MANUFACTURER'S INSTRUCTIONS. ALL  
 COLOURS TO BE CONFIRMED BY THE CA PRIOR TO  
 COMMENCEMENT.

DISABLED CHANGING  
 SUPPLY AND FIT TWYFORDS DOC.M VALUE PACK, BLUE GRAB  
 RAILS & SEAT INCLUDING ADDITIONAL HINGED GRAB RAIL TO  
 THE SIDE OF THE TOILET. ALL GRAB RAILS TO BE IN BLUE.  
 INCLUDES ALL FITTINGS & WASTES.  
 LAYOUT, POSITION OF APPLIANCES AND GRAB RAILS TO BE IN  
 ACCORDANCE WITH DIAGRAMS 18 & 19 AS DETAILED IN PART M  
 OF THE APPROVED DOCUMENTS.  
 SUPPLY AND FIT MIRROR ABOVE WHB.  
 LEVEL ACCESS SHOWER TO BE FITTED WITH DROP DOWN SEAT  
 & GRAB RAILS. ALL TO COMPLY WITH BUILDING REGULATIONS  
 PART M DIAGRAM 23.

UNDERGROUND DRAINAGE  
 ALLOW FOR ALL UNDERGROUND FOUL DRAINAGE 110MM UPVC  
 DRAINAGE BEDDED IN PEA GRAVEL, ALLOWING FOR ALL  
 CONNECTIONS, JUNCTIONS BENDS ETC AS NECESSARY.  
 INCLUDE FOR ALL EXCAVATION THROUGH HARD AND SOFT  
 SURFACES AND MAKING GOOD AS NECESSARY.  
 SHUTTER AROUND NEW PIPES AND PROVIDE PRECAST  
 CONCRETE LINTELS AS NECESSARY WHERE DRAINAGE RUNS  
 THROUGH FOUNDATIONS.  
 ALLOW FOR RODDABLE TRAPPED GULLEYS TO PICK UP WASTE  
 FROM SINKS.

FLOOR COVERINGS  
 TO 3No. CHANGING ROOMS & SERVERY SUPPLY AND FIT NEW  
 FLOOR COVERINGS - WITH CS CAPPING STRIPS TO COMMUNITY  
 ROOM. INCLUDE FOR ANY SELF LEVELLING SCREEDS AS  
 NECESSARY PRIOR TO LAYING.

SERVERY  
 SUPPLY AND FIT ELECTRICALLY OPERATED INTERNAL ROLLER  
 SHUTTERS TO OPENINGS AN ACCURATE SITE MEASURE BY  
 CONTRACTOR IS REQUIRED PRIOR TO MANUFACTURE. 75MM  
 LATHS. ALL METALWORK TO BE GALVANISED & POLYESTER  
 POWDER COATED. COLOUR TO BE SELECTED BY CLIENT

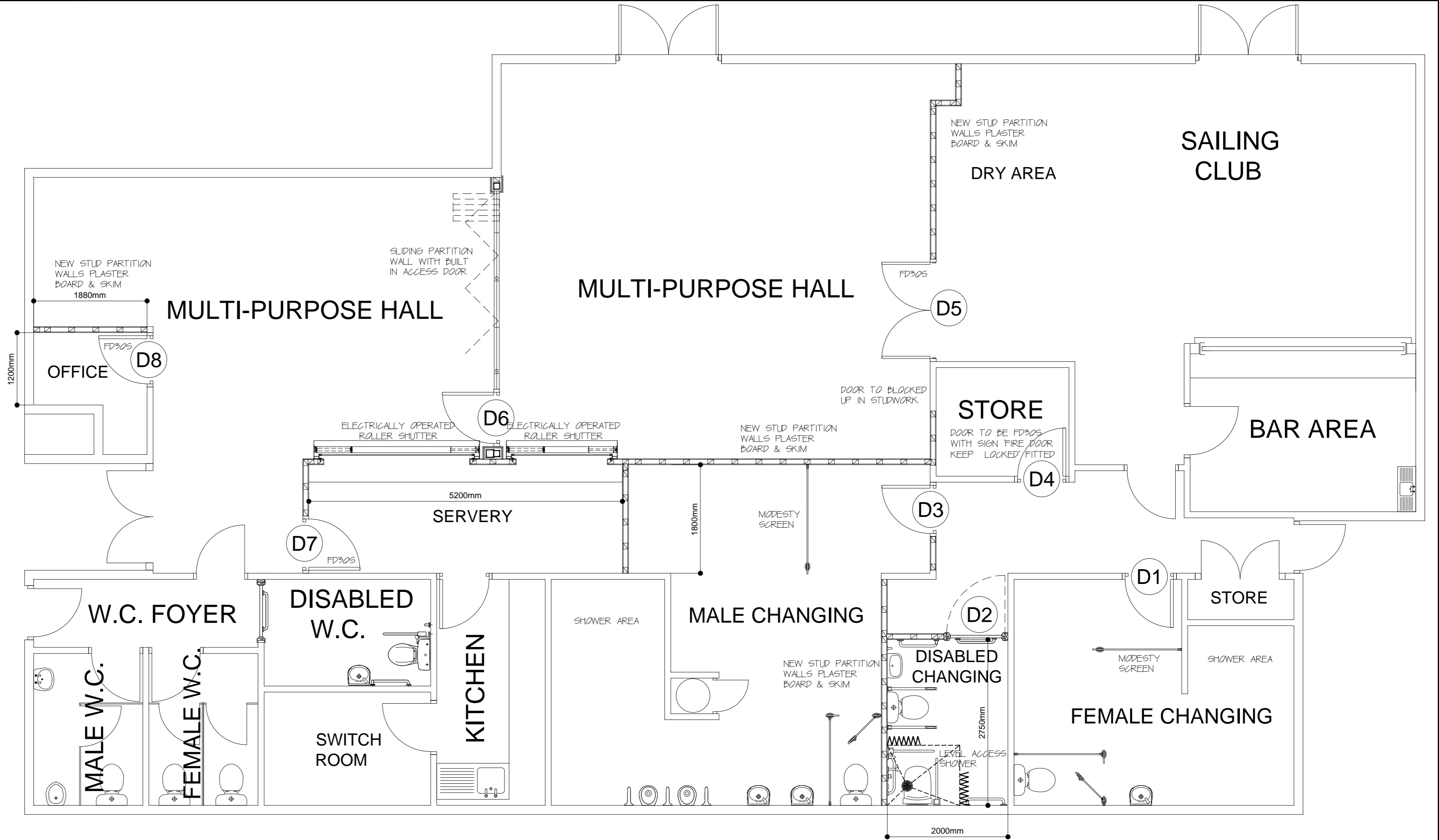

**PROPOSED FLOOR PLAN**



Strategic Director:  
 Karl Battersby Bsc (Hons) MTPL MRTPI

Rotherham Metropolitan Borough Council  
 Environment & Development Services  
 Riverside House, Main Street,  
 Rotherham S60 1AE

Client:

Rev.	Description	Date	Initial	Chd.

Project Ulley Country Park  
 Visitors Centre  
 Title Internal Alterations  
 Proposed Floor Plans

Dwg. No. 005/002/027 - 03

Rev

Scales (if A2) 1:50

Drawn David Ryder

Date 18/03/2015

Chd. by